

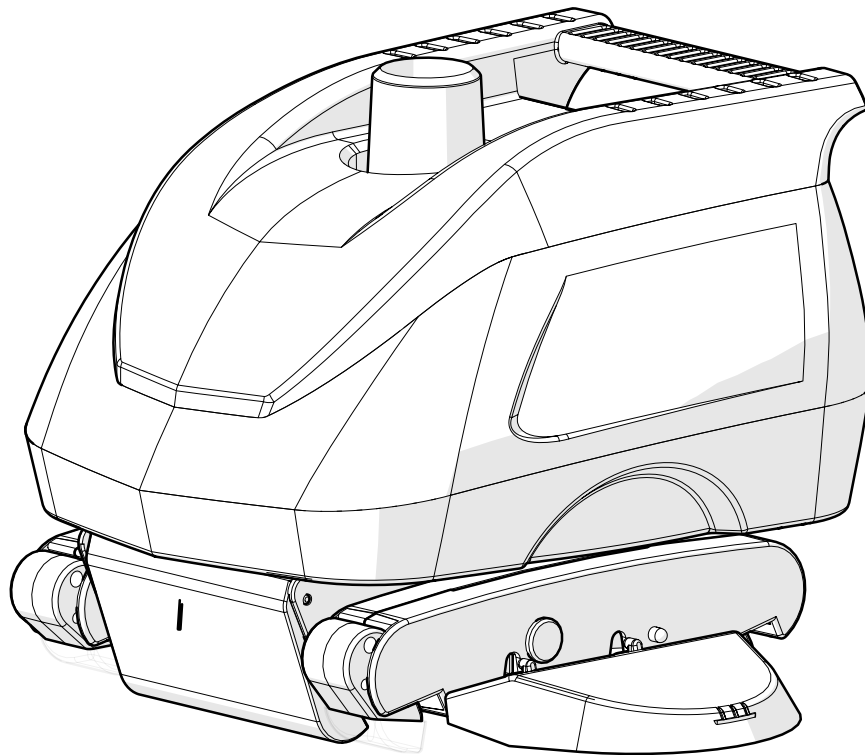

INSTALLATION MANUAL



877.768.2717 FAX: 877.276.POOL (7665)

Outside the U.S.: +1.805.620.5060 FAX: +1.949.336.1940

www.aquastarpoolproducts.com info@aquastarpoolproducts.com

★★ PROUDLY MADE
★★ IN THE USA



CONTENTS

FULL KIT INCLUDES CLEANER, SEVEN CONNECTOR HOSES, ONE LEADER HOSE, FLOW GAUGE, SKIMMER CONE, AND OWNER'S MANUAL.

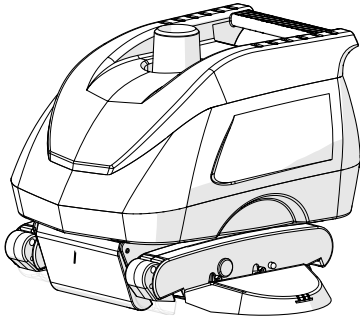

Aqua Rover Cleaner Head

Part # - AQR1601-H (Concrete)

Part # - AQRV1601-H (Vinyl/Fiberglass)

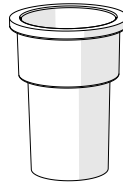

Skimmer Cone

Part # - HWN152

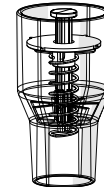

Flow Gauge

Part # - HWN153



Leader Hose

Part # - SZTHL



Connector Hoses (x7)

Part # - SZTH

See pages "PROSTAR REPLACEMENT KITS" on 16-18 for a complete list of replacement parts and kits

Pro Accessory

Use Aqua Rover's optional Leaf Catcher for maximum efficiency.

To keep the cleaner working optimally without stopping to open and clean the pump strainer basket, use the ProStar™ Leaf Catcher. The Leaf Catcher captures leaves and other debris poolside, where it's easy to see, open, and clean.

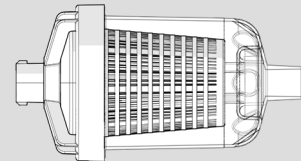

Leaf Catcher

Part # - HWN162

Aqua Rover features:

- Advanced cruise control technology
- Designed movement for better cleaning
- Efficient, quiet operation
- Engineered for enhanced durability
- Simple installation, no additional tools required
- Easy grip roll bar handle



Advanced Cruise Control Technology

Automatically controls the AquaRover's speed to ensure best performance and longevity in any pool system.



THE AQUA ROVER CLEANER IS NOT INTENDED TO PULL OR TOW ANY THIRD-PARTY ATTACHMENTS. ANY ADDITIONAL UNINTENDED DRAG CAUSED BY THIRD-PARTY ATTACHMENTS CAN PREMATURELY WEAR DOWN THE COMPONENTS AND MAY VOID THE WARRANTY DUE TO IMPROPER USE.



IMPORTANT NOTES



Welcome! Thank you for purchasing the Aqua Rover automatic pool cleaner.

The Aqua Rover automatic pool cleaner works from the suction side of your pool filter system and is subject to the GPM (gallons per minute) of the suction line. It is designed to operate and install simply with most swimming pools. Occasionally, additional hoses and/or parts are needed to complete your special situation. For technical assistance and parts availability, call your local Aquastar Pool Products dealer.

Keep this installation manual on file – with your receipt, purchase date, and serial number.

Before installing the Aqua Rover automatic pool cleaner:

- Manually clean/vacuum the pool and clean all skimmer, pump and debris baskets.
- Clean or backwash the filter.
- Check that the water is at its proper level.
- Check water chemistry. Make sure the pool is free from excess algae to ensure proper operation.
- Never use the Aqua Rover automatic pool cleaner to remove plaster/pebble debris in new or remodeled pools.
- Always remove the Aqua Rover automatic pool cleaner before backwashing or chemically shocking the pool.

How to properly store the Aqua Rover:

Always remove the Aqua Rover automatic pool cleaner and hoses before swimmers enter the pool. It is not a toy and is not intended for children to play with.

When removed from the pool, keep the Aqua Rover automatic pool cleaner disconnected and stored in a shaded, safe place – away from all chewing animals!

The hoses must be stored straight. **DO NOT COIL!**

Carry the Aqua Rover automatic pool cleaner by the handle only.

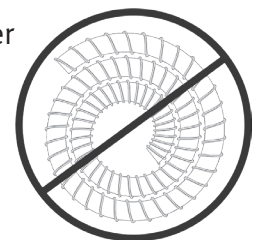

**DO NOT
COIL HOSES!**

SAFETY FIRST! - Dedicated vacuum line

Always install a USPC-approved safety vacuum lock with sidewall connections. When the Aqua Rover automatic pool cleaner is removed, make sure the safety vacuum lock wall fitting cap is securely covering the sidewall suction port and snapped shut.

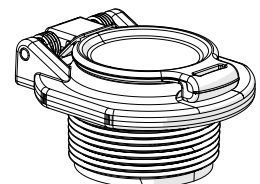

**Step 1a: Connect the cleaner (Fig. 1)**

There are seven connector hoses and one leader hose with a gray hose cuff. The hose cuff connects to the top of the Aqua Rover automatic pool cleaner.

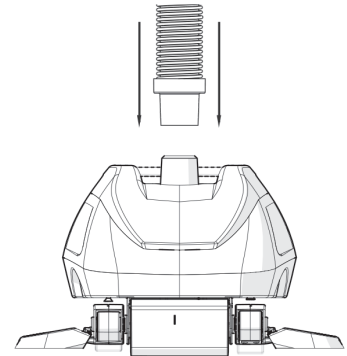

Fig. 1

Step 1b: Connect the hoses (Fig. 2)

Connect the Aqua Rover automatic pool cleaner hose sections by pushing and twisting the tapered male connector end of each hose firmly into the open female end of the adjacent hose section.

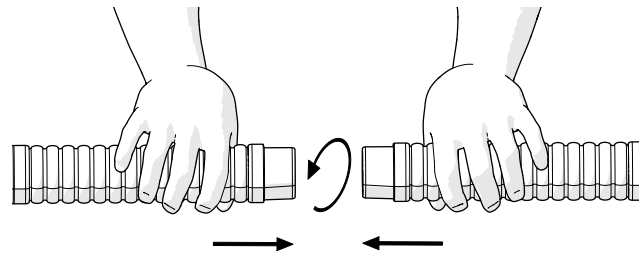

Fig. 2

Step 1c: Submerge the hoses and cleaner

After the correct hose length has been assembled, fill the hose completely with water by lowering the attached Aqua Rover automatic pool cleaner and then vertically pushing the hose down, allowing all the air to escape.

Beginner Tip Have the proper length of hose so the cleaner can reach all areas of the pool.

The hose should reach from the skimmer or safety vacuum lock wall fitting to the furthest point in the pool plus one extra hose section. If the hose is not long enough, it will be necessary to purchase additional hose sections from your pool dealer. Depending on the size and shape of your pool, all hose sections might not be used.

Do you own a leaf canister?

If an optional leaf canister is purchased, install between first and second hose sections (see Fig. 3).

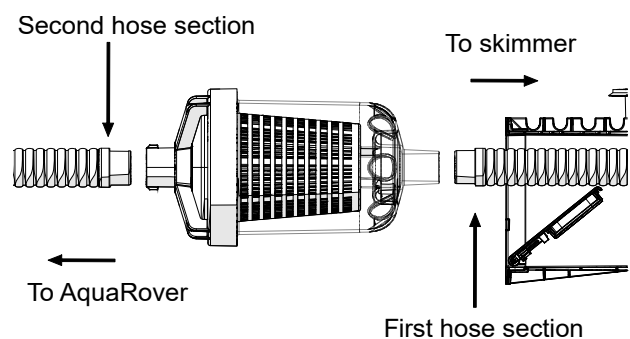

Fig. 3

CONNECT SUCTION SOURCE

INSTALLATION STEP 2



Step 2: Connect the skimmer to the suction source (two options available):

Option A - Skimmer port

The suction port of the skimmer, with skimmer cone and connector hose (see Fig. 4).

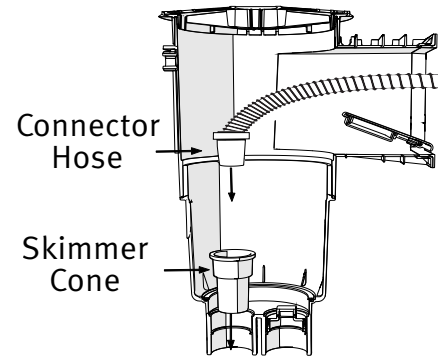

Fig. 4

Option B - Dedicated suction port:

The wall port safety vacuum lock with connector hose (see Fig. 5).

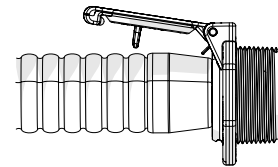

Fig. 5

TEST THE CLEANER'S FLOW

INSTALLATION STEP 3



How to connect the flow gauge

Ensure that the hose is full of water and that your pump is running. Remove the cleaner from the hose, then insert the flow gauge into the leader hose. Make sure the flow gauge is underwater (see Fig. 6), and with the opposite end of the hose attached to a dedicated suction port or skimmer port.

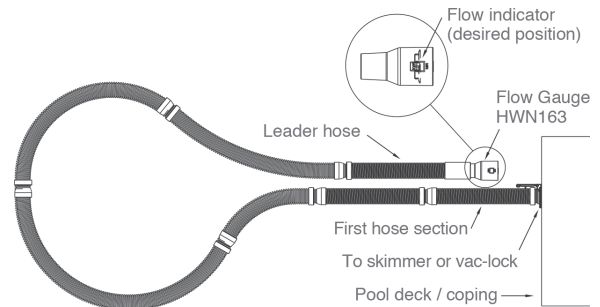

Fig. 6

Check pump, filter, and use the flow gauge regularly to ensure optimal performance

Pro Tip

For best performance, ensure that if you have a variable speed pump that it is on the proper setting and that your filter is kept clean. A variable speed pump may automatically switch between low and high settings and increased pressure at the filter can cause fluctuations to the cleaner's suction. Regularly use the flow gauge to ensure that the cleaner is running optimally.

How to use the flow gauge

Observe the flow gauge. The optimal level is between the MAX and MIN lines of the flow gauge (see Fig. 7).

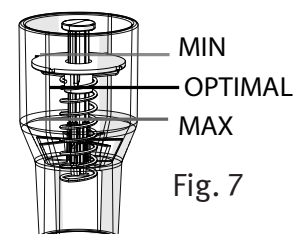

Fig. 7

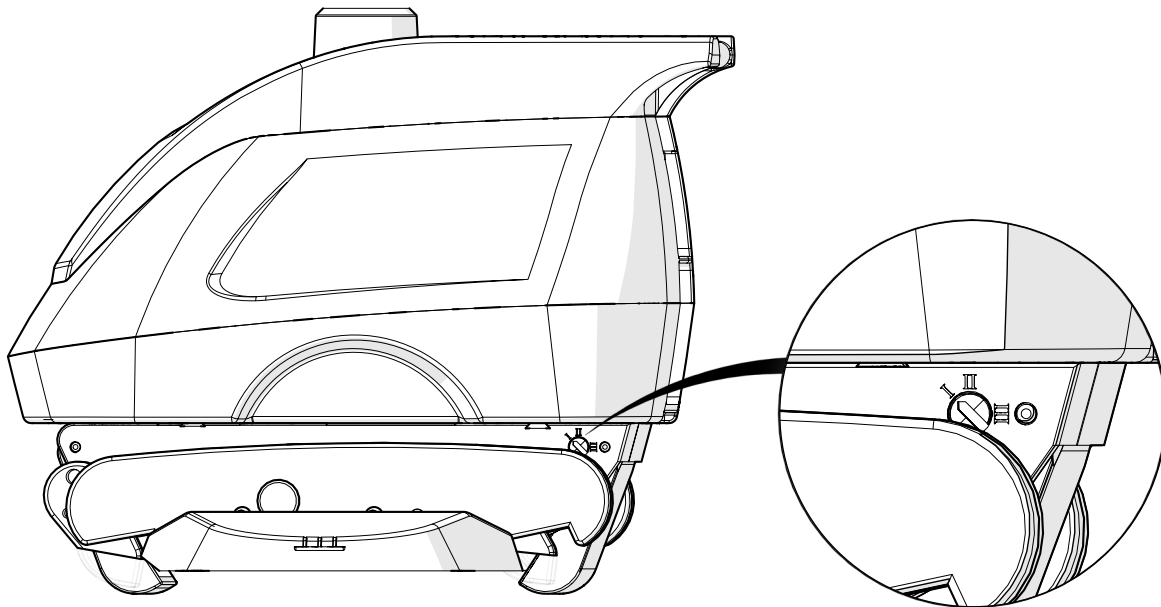

Fig. 8

How to adjust cleaner tension

The rear flap tension adjuster is preset to II. The tension adjustment controller is located in the rear of the unit (see Fig. 8). To adjust tension use a flat head screwdriver to rotate the tension controller.

How to adjust if the cleaner is becoming trapped

When the Aqua Rover automatic pool cleaner seems to be spending too much time against steps, vertical walls, and other obstructions, turn the rear flap tension adjuster to position I (see Fig. 8). Custom pools with interior bar stools, fountains, planters, etc., will require someone to physically free the cleaner in the case that it becomes trapped.

How to adjust the cleaner if it is not climbing walls

The Aqua Rover automatic pool cleaner will climb vertical walls in concrete and fiberglass pools (not vinyl) if there is at least a 12-inch radius where the floor meets the walls. The cleaner will not climb or go all the way up the wall every time due to the programmed gearbox. If the Aqua Rover automatic pool cleaner is not sticking to the wall, set the rear flap tension adjuster to position III (see Fig. 8).

How to adjust the cleaner if it is going above the waterline

If the cleaner climbs above the waterline and sucks in air, set the rear flap tension adjuster to position I (see Fig. 8).

How to remove access cover and clear debris from the main turbine

Should the Aqua Rover automatic pool cleaner stop moving or become sluggish due to debris trapped in the throat or inside the unit, the turbine/vacuum chamber is accessible following these instructions.

1. Disconnect Aqua Rover automatic pool cleaner from leader hose and remove from the pool.
2. Turn Aqua Rover automatic pool cleaner upside down.
3. Locate and loosen the captive screw behind the throat in the center of the bottom (see Figs. 9 & 10).
4. Lift fixed access cover (see Fig. 10).
5. Clean the turbine/vacuum chamber (see Fig. 11).
6. Check the turbine for free movement.
7. Reinstall the fixed access cover by lining it up with the two slots. (see Figs. 9 & 10).
Slide the cover in place and tighten the captive screw.
10. Reinstall Aqua Rover automatic pool cleaner in pool per installation instructions.

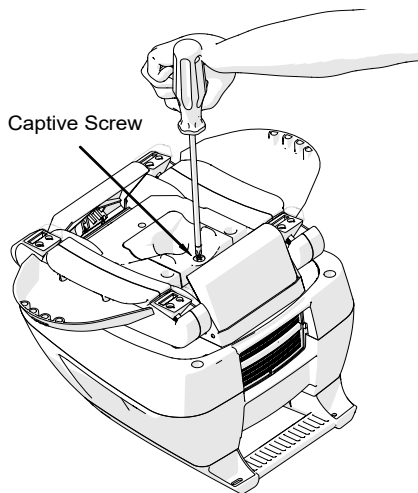

Fig. 9

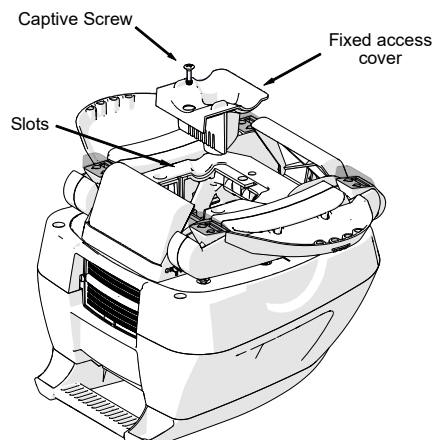

Fig. 10

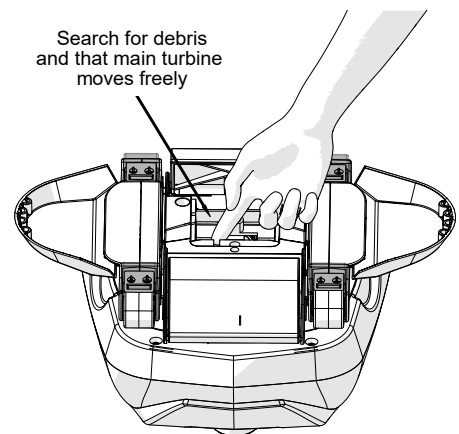

Fig. 11

The main turbine should rotate freely when blowing into the access cover opening. Pro Tip

To ensure that your main turbine is in optimal condition, take the fully assembled cleaner and blow into the access cover. The main turbine should turn freely and the pods should move. If not, remove the access cover and ensure that there are no further debris. If the main turbine is not rotating freely after clearing all debris it may need to be replaced, see page 16 for replacement kit.

How to check the condition of the shoes

The pod shoes and wings have wear indicators on their sides and should occasionally be checked to determine if replacement is needed. The shoe wear indicator is a line on the side of the pod shoe that appears as a difference in texture. When this texture difference is no longer visible at the bottom of the shoe when viewed from either side, the shoes must be changed (see Fig. 12).

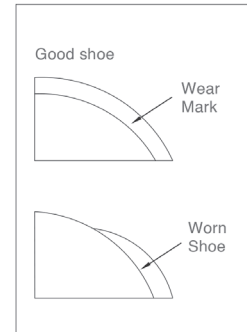

Fig. 12

How to replace the pod shoes

1. Turn the unit upside down.
2. Insert a screwdriver between foot and shoe on one of the pods (see Fig. 13).
3. Using a lifting motion, remove the shoe from the foot.
4. Dip a new shoe in water and attach the shoe to the foot, making sure to put the small post into the small hole and the large post into the large hole. These posts and holes are different sizes to prevent the shoes from being improperly installed.
5. Repeat steps 2, 3, and 4 for each shoe.

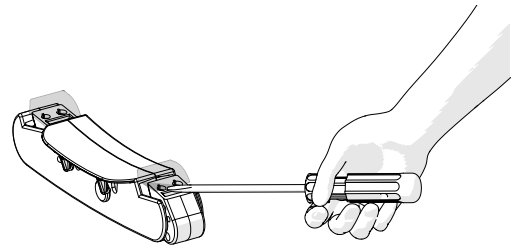

Fig. 13

How to check the condition of the wings

The wing wear indicator is located on the side and is a horizontal line that has three vertical lines above it. When you can no longer see the horizontal line, the wings must be replaced (see Fig. 14)

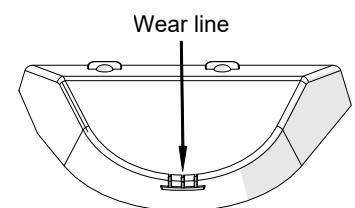

Fig. 14

How to replace the wings

1. Using a screwdriver, remove the plugs from the pod (see Fig. 18).
2. Unscrew and remove the hex bolt that was covered by the plug.
3. Remove pod by placing equal pressure on both ends of the pod until it releases from the cleaner body.
4. Remove the wing by tilting it toward the pod and placing pressure up (See Fig. 15).
5. Install the new wing by aligning it with its two posts, tilting it toward the pod, and placing pressure down.
6. Repeat steps for other wing.

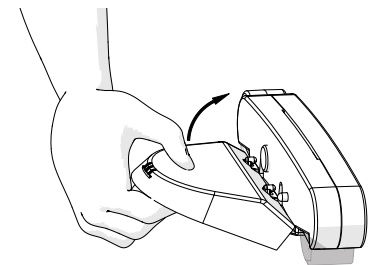

Fig. 15

How to tell if the pods need to be replaced

The pod is the walking leg of the unit that holds both the pods shoes and wing (see Fig. 16). If the cleaner’s pods are worn the cleaner may experience slow or no forward movement. If only one pod is worn the cleaner may only go in one direction.

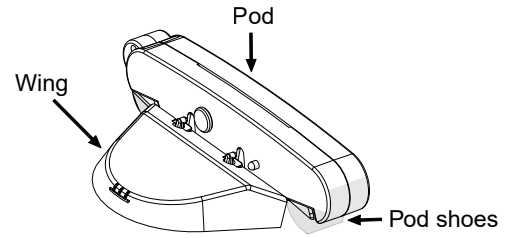

Fig. 16

How to check the condition of the pods

1. Turn the unit upside down.
2. Apply firm pressure on the opposite pod that you would like to check.
3. With pressure applied, use your other hand and press down on the other pod, on the end that is raised. This is the pod being tested (see Fig 17).
4. A pod that is in good condition shouldn’t move more than 1/4 of an inch. Ensure that the pod is not loose. The pod shouldn’t move more than 1/4 of an inch.
5. Check the opposite pod by repeating step 2.

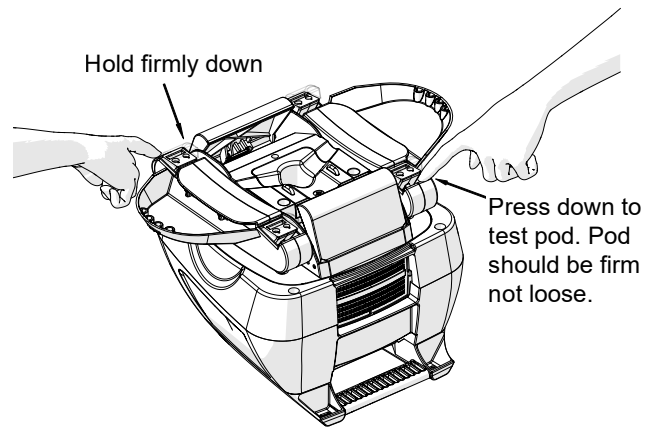

Fig. 17

How to replace the pods:

1. Using a screwdriver, remove the plugs from the pod (see Fig. 18).
2. Unscrew and remove the hex bolt that was covered by the plug.
3. Remove pod by placing equal pressure on both ends of the pod until it releases from the cleaner body.
4. Install new pod and replace and tighten hex bolt. Ensure that the pod moves smoothly and freely.

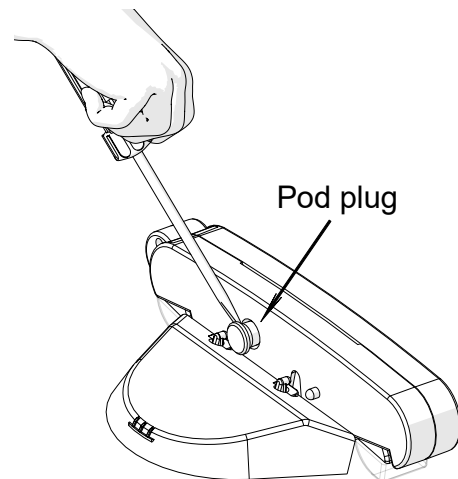

Fig. 18

How to tell if the flaps need to be replaced

The flaps help allow the cleaner to climb walls and can be adjusted (See Pg. 6 Step 4). If the flaps are worn the cleaner may experience trouble climbing vertical walls or may float up from the floor.

How to remove the flaps

Remove the front and rear flaps from your Aqua Rover automatic pool cleaner by inserting a small screwdriver between the flap and the lower body near the pivot point of the flaps (see Fig. 19).

How to identify rear and front flaps

You will notice that your replacement flaps look similar but are marked “Front” and “Rear” on the flap. It is necessary to install the proper flap in the front and rear of the unit because the springs in the flaps are different. Failure to do so will result in unsatisfactory performance of the Aqua Rover automatic pool cleaner.

How to install front and rear flaps

When installing the front flap, be sure that the extended leg of the spring is inserted into the notch on the front of the lower body. Secure the flap by first placing one of the corner tabs into its corresponding hole and then carefully pushing the other edge in to secure the final tab in place. You will feel and hear a snap when the flap falls in place. Fold the flap in toward the bottom of the Aqua Rover automatic pool cleaner. You will feel some resistance at this point (that is normal). As the flap snaps into its normal position, you will feel the spring action and notice that the front flap is now in its normal operating position.

When installing the rear flap, the extended leg of the spring must fit against one of the flat surfaces of the cam (see Fig. 20).

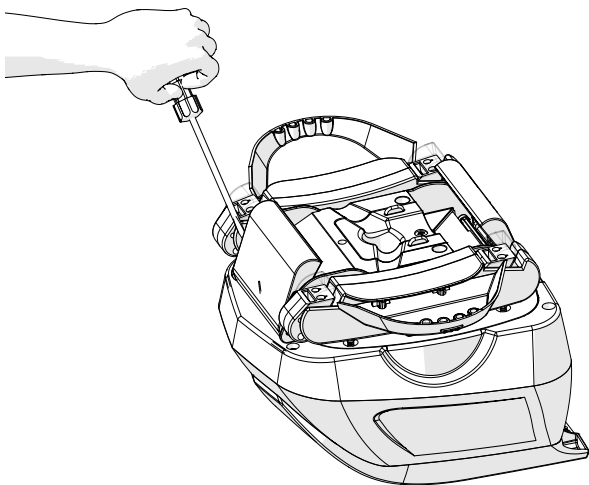

Fig. 19

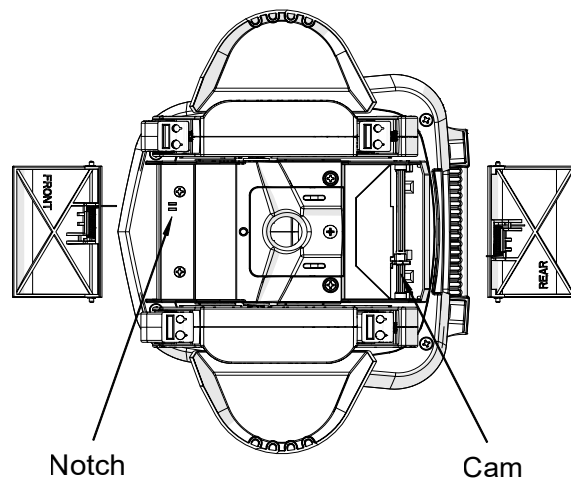

Fig. 20



How to tell if the bumper needs to be replaced

If the bumper show signs of major wear it should be replaced. A hole or crack on the bumper can cause problems with the cleaner's operation.

Replacing the bumper is not recommended to be repaired by beginners

Pro Tip

Replacement of the Aqua Rover automatic pool cleaner bumper is not recommended as a “do it yourself” repair, because there is a slight possibility that the replacement might cause a problem in the propulsion system. We strongly suggest that you consult your dealer for this repair.

Aqua Rover automatic pool cleaner bumper replacement

1. Turn Aqua Rover automatic pool cleaner upside down and place it in a position that is steady/firm.
2. Locate and loosen the captive screw behind the throat in the center of the bottom (Figs. 21).
3. Lift the access cover (see Figs. 11 & 12, Pg. 7).
4. Remove lower body screws (see Fig. 21).
5. Lift the lower body assembly off the Aqua Rover automatic pool cleaner (see Fig. 21).
6. Remove four bumper screws (see Fig. 21).
7. Remove the bumper carefully, do not tamper with any other cleaner parts.
8. Replace with a new bumper, do not tamper with any other cleaner parts
9. Reinstall screws and parts, following steps in reverse – 6 , 5 , 4 , 3 , 2.
10. Reinstall Aqua Rover automatic pool cleaner in pool per installation instructions.

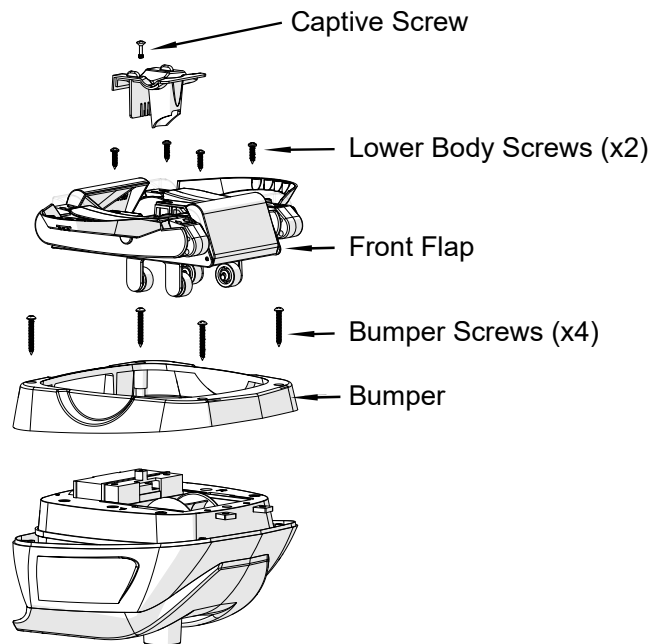

Fig. 21



TROUBLESHOOTING

Problem: Slow / no forward movement

CAUSES	SOLUTIONS
Lack of/improper water flow through cleaner	Check and adjust water flow, Pg. 6
Partial obstruction of Aqua Rover throat	Clear obstruction, Pg. 7
Worn shoes	Replace shoes, Pg. 8
Worn wings	Replace wings, Pg. 8

Problem: Cleaner fails to climb vertical walls gunite/concrete pool

CAUSES	SOLUTIONS
Improper shoes for application	Contact your local Aquastar Pool Products dealer
Lack of/improper water flow through cleaner	Adjust water flow, Pg. 5 -6
Partial obstruction of Aqua Rover throat	Clear obstruction, Pg. 7
Worn shoes	Replace shoes, Pg. 8
Worn wings	Replace wings, Pg. 8
Hose too short	Install additional hose sections, Pg. 4
Improper tension on rear flap	Turn rear flap adjuster to III, Pg. 6

Problem: Cleaner climbs to the surface and sucks air

CAUSES	SOLUTIONS
Too much/improper water flow through cleaner	Adjust water flow, Pg. 5-6
Improper tension on rear flap	Turn rear flap adjuster to I If still climbing too much, reduce water flow until the proper operation is achieved, Pg. 6
Steering failure	<ol style="list-style-type: none"> 1. Check and clean rear screen 2. Check to see that cone gear is free and rotates smoothly in both directions 3. Check medium turbine and spindle gear assemblies for malfunction. This will require the unit be disassembled, if you are not comfortable with the cleaner's assembly please seek professional help.

Problem: Cleaner head floats

CAUSES	SOLUTIONS
Cleaner head or return line has air in it	<p>Remove all air from cleaner head</p> <p>Stop all air from entering the pool through the return lines</p> <p>If cleaner head and hose are covered with fine bubbles, give the hose a good tug. This will release the air bubbles and allow the cleaner head to settle to the bottom of the pool until the hose is covered with bubbles again</p>
The cleaner head is being pulled or lifted off the bottom of the pool by the cleaner hose or return line flow – either at the surface or at the bottom of the pool – or both	Readjust return lines to prevent water flow from interfering with cleaner head and/or hose



TROUBLESHOOTING

Problem: Cleaner sticks at steps, corners, etc.

CAUSES	SOLUTIONS
Improper water flow	Check and adjust water flow, Pg. 5-6
Worn shoes	Replace shoes, Pg. 8
Worn wings	Replace wings, Pg. 8
Hose too short	Install additional hose, Pg. 4
Steering failure	<ol style="list-style-type: none"> 1. Check and clean rear screen 2. Check to see that cone gear is free and rotates smoothly in both directions 3. Check steering program and troubleshoot – then: <ol style="list-style-type: none"> A. Clean, repair, or replace the gearbox B. Check pod/A-frame connection and replace if necessary – do not attempt to retighten loose pods C. Check medium turbine and spindle gear assemblies- <i>This will require the unit be disassembled, if you are not comfortable with the cleaner’s assembly, please seek professional help.</i>



DISCLAIMER

- A. Pool plaster is affected by age, water chemistry, etc.
- B. Pool plaster can deteriorate over a period of time.
- C. The integrity of “good” pool plaster is such that a pool vacuum cleaner – automatic or manual – cannot remove that plaster.
- D. The integrity of “good” pool plaster is such that the plaster will cause wear on the Aqua Rover automatic pool cleaner – not vice versa.
- E. Vinyl and fiberglass are affected by age, sunlight and water chemistry.
- F. Vinyl can become brittle and weak.

- G. Vinyl can also be affected by the installation and the pool’s surroundings.
- H. When installing the Aqua Rover automatic pool cleaner, you assume all responsibility for the condition of the pool and the pool’s surroundings.

To better serve you, please have the following information available if you contact your local Aquastar Pool Products dealer.

1. The purchase date and purchase location of your Aqua Rover automatic pool cleaner.
2. The serial number of your Aqua Rover automatic pool cleaner.
3. The number of hose sections used.

WARRANTY

This limited warranty is extended to the original purchaser (consumer) from the manufacturer of the Aqua Rover Automatic Pool Cleaner.

Aquastar Pool Products warrants this cleaner to be free from defects in materials and workmanship for a period of one year from the original date of purchase subject to all the following conditions and exclusions.

1. Should the cleaner fail to be in good working order in accordance with the above schedule, Aquastar Pool Products will at its option repair or replace the cleaner or any defective parts at no additional charge except as set forth below. Repair parts and replacement products will be furnished on an exchange basis and will be new or functionally equivalent. All parts removed as a result of replacement shall become the property of Aquastar Pool Products. Liability of Aquastar Pool Products and the sole remedy of the purchaser whether in contract under any warranty, in tort (including negligence), in strict liability or otherwise, shall be limited to the repair or replacement of defective parts only and shall in no event exceed return of the amount of the purchase price paid by the purchaser.
2. This limited warranty is for the replacement of alleged defective parts during the term of the warranty. Aquastar Pool Products, upon determination and at our option, will repair and return to the owner all defective parts that are covered by this warranty. Any parts not covered by this limited warranty will be returned to owner freight collect.
3. This limited warranty is only extended to the original purchaser (consumer) and only during the time in which the original purchaser occupies the premises where the cleaner was originally installed. It does not apply to any subsequent purchasers or recipients of the cleaner.
4. This limited liability warranty includes the replacement of parts due to normal wear but does not include cosmetic situations including but not limited to: discoloration or fading due to sunlight or chemicals, scratches, scuffs, etc.
5. This limited warranty does not cover any loss, damage, injury, or malfunction of the equipment due to the failure to properly maintain and or operate the cleaner, or alteration of the equipment, tampering, and act of God, abuse, misuse, negligence, omissions.
6. This cleaner is intended for a properly designed and maintained swimming pool. This limited warranty does not cover pools that have a defective design, are improperly maintained, and are inappropriate for the Aqua Rover automatic pool cleaner's operation.
7. This limited warranty does not cover damage or injury from improper installation, pump running dry, damage due to loss of prime or plugged pipes.
8. This limited warranty does not cover any change in appearance, damage, malfunction due to chemical reactions, etc.
9. Aquastar Pool Products is not responsible for any loss of time, inconvenience or any consequential expenses such as telephone calls, labor, etc., unless required by law.
10. Deterioration, discoloration or brittleness of pool plaster and vinyl liners can be caused over time separately by or in combination with, age and an imbalance in pool water chemistry, improper installation and other factors. Aquastar Pool Products hereby disclaims any and all claims, and purchaser releases Aquastar Pool Products from any and all claims for damages to any pool plaster or vinyl liner in purchaser's pool by reason of the use and/or operation of the cleaner.
11. This limited warranty is only valid in the USA and Canada.
12. This limited warranty is in lieu of any other warranties express or implied, including the warranties of merchantability or fitness. Any such implied warranty imposed by state consumer law is limited in duration to one year from date of purchase.

No distributor, dealer or representative has any authority to make any warranties express or implied concerning Aqua Rover automatic pool cleaner except as contained herein. Unless warranty card has been received by Aquastar Pool Products, Aquastar Pool Products reserves the right to refuse repair service or to honor warranty.



877.768.2717 FAX: 877.276.POOL (7665)

Outside the USA: +1.805.620.5060 FAX: +1.949.336.1940

www.aquastarpoolproducts.com info@aquastarpoolproducts.com



PROSTAR REPLACEMENT PARTS

PROSTAR™ ALL-AMERICAN REPLACEMENT PARTS FOR THE AQUA ROVER™ AUTOMATIC POOL CLEANER



A DIVISION OF AQUASTAR POOL PRODUCTS

Discover the quality, price and selection of these dependable Aquastar Pool Products replacement parts. Each one is made to last in the USA, and engineered for a perfect fit.

(877) 768-2717
prostarreplacementparts.com



STANDARD COLOR CODES

- White - 01
- Black - 02
- Light Gray - 03
- Dark Gray - 05
- Tan - 08

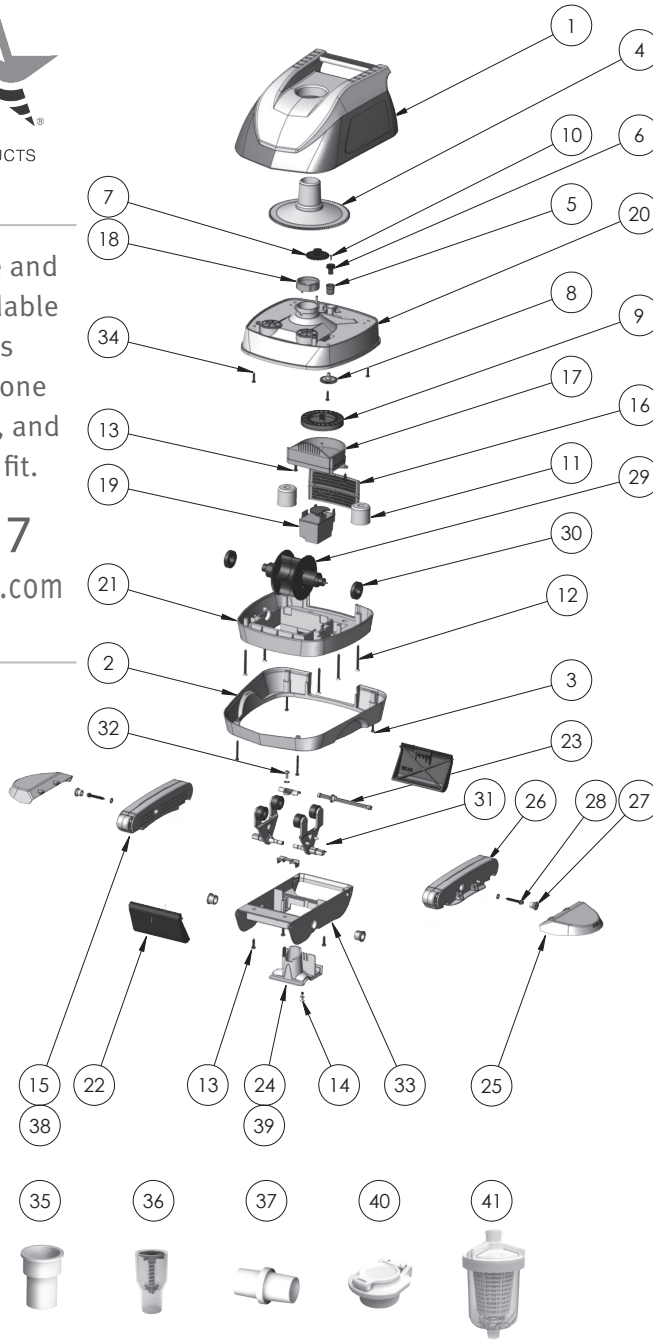

1. Cover - HWN169
2. Bumper - HWN168
3. Bumper Screw Kit, (4 pack) - HWN170
4. Cone Gear, Clear - HWN122
5. Spindle Gear Bushing - HWN127
6. Spindle Gear - HWN126
7. Intermediate Gear - HWN123
8. Medium Turbine Drive Gear - HWN127
9. Medium Turbine - HWN127
10. Spindle Gear Screw - HWN125
11. Float Kit, 2 Pack - HWN136
12. Middle Body Screw, 6 Pack - HWN139
13. Upper Body Screw, 6 Pack - HWN130
14. Captive Screw and Retaining Clip - HWN148
15. Pod Shoes, For Concrete, 4 Pack - HWN115
16. Rear Screen - HWN135
17. Turbine Case w/Axle - HWN133
18. Cone Gear Bushing - HWN128
19. Gear Box Assy. - HWN134
20. Upper Middle Body w/Cruise Control - HWN167
21. Lower Middle Body - HWN137
22. Flap Kit, Front & Rear w/Springs - HWN143
23. Flap Adjuster - HWN141
24. Fixed Access Cover Assy. For Concrete - HWN149
25. Wing Kit: Left and Right Wings - HWN1701
26. Pod Kit, Left & Right Pods, Plugs, Screws & Washers - HWN114
27. Pod Plugs, 6 Pack - HWN111
28. Pod Screw Kit, 2 Hexhead Screws, 2 Washers - HWN116
29. Turbine Kit, Turbine & (2) Turbine Bearings - HWN113
30. Turbine Bearings, 2 Pack - HWN112
31. Universal A-Frame Kit - HWN118
32. Lower Body Screw Kit, Screw and Washer - HWN140
33. Lower Body - HWN142
34. Upper Body Screw Kit, 4 Pack - HWN171
35. Skimmer Cone - HWN152
36. Flow Gauge - HWN153
37. Hose Connector - HWN158
38. Pod Shoes, For Vinyl, 4 pack - HWN114
39. Fixed Access Cover Assy. For Vinyl - HWN157
40. 1½ Threaded Safety Vacuum Lock Wall Fitting - VLK15Tx (See Standard Colors Codes For "xx")
41. Leaf Canister - HWN162

PROSTAR REPLACEMENT KITS



We've made your pool equipment service and repair a lot easier with these convenient replacement kits. Each one is a complete grouping that contains everything you need for that particular repair. For more information or to stock up on individual replacement parts at prostarreplacementparts.com or call 877-768-2717.

Medium Turbine/Spindle Gear Kit
HWN154

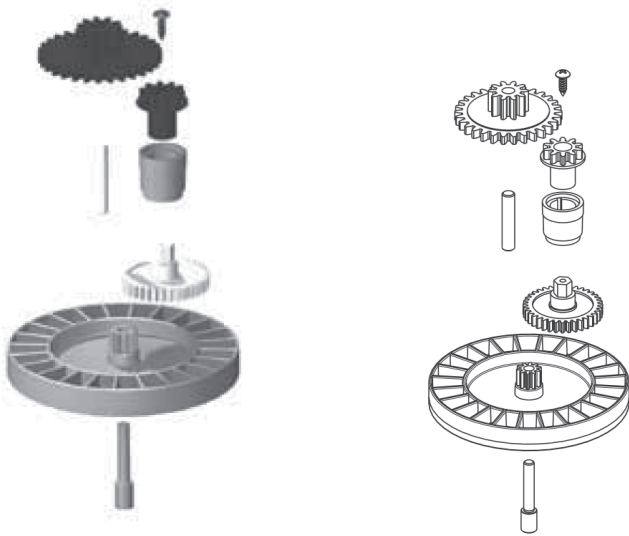

Universal A-Frame Kit
HWN118

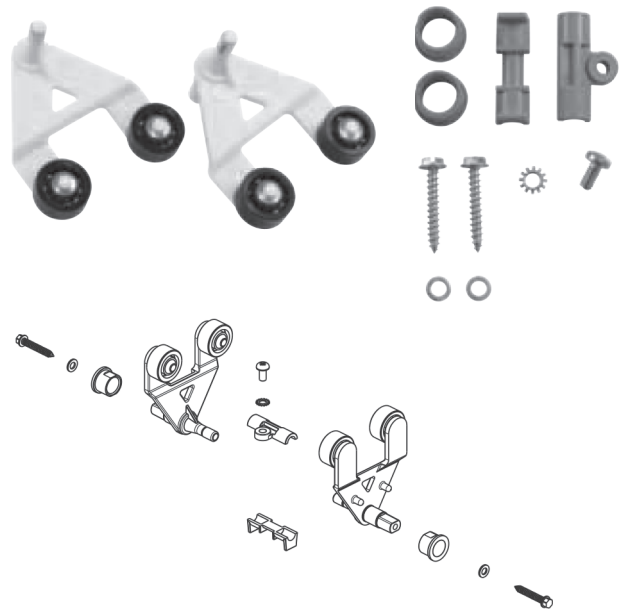

Turbine Kit: Turbine and
Two Turbine Bearings
HWN113

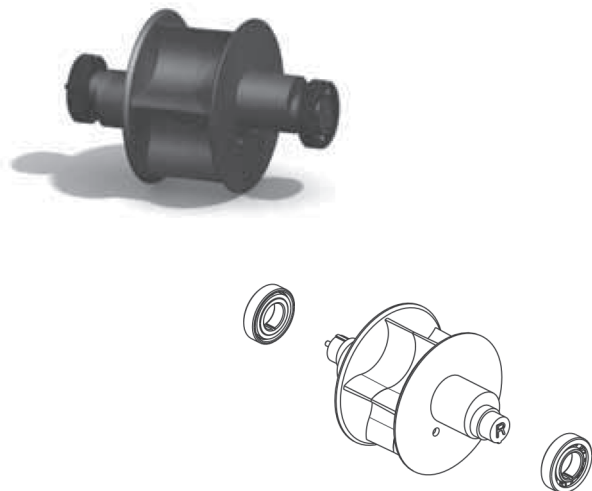

A-Frame/Bushing/Saddle Kit
HWN120

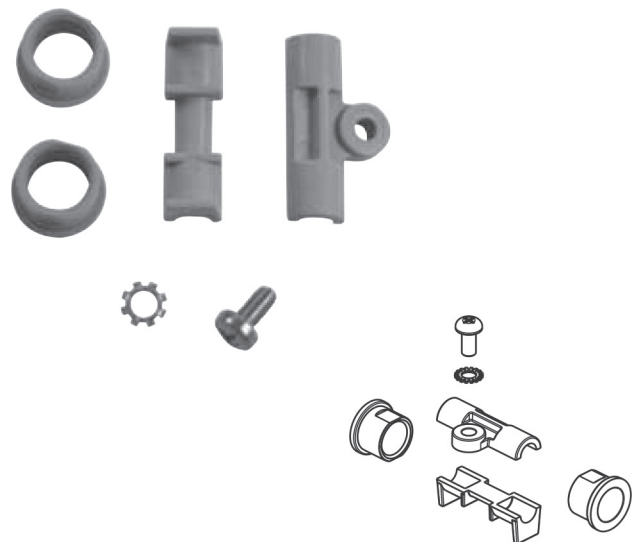



PROSTAR REPLACEMENT KITS

We've made your pool equipment service and repair a lot easier with these convenient replacement kits. Each one is a complete grouping that contains everything you need for that particular repair. For more information or to stock up on individual replacement parts at prostarreplacementparts.com or call 877-768-2717.

Propulsion/Conversion Kit
HWN16001

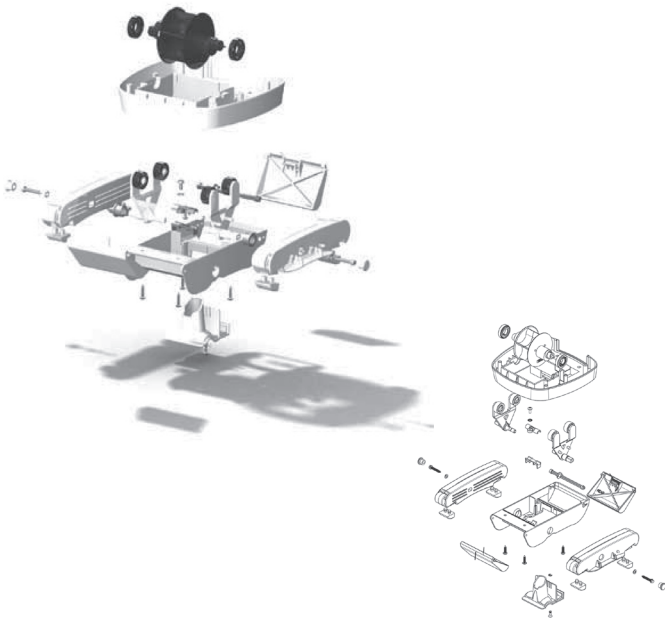

A-Frame and Turbine Kit
HWN119

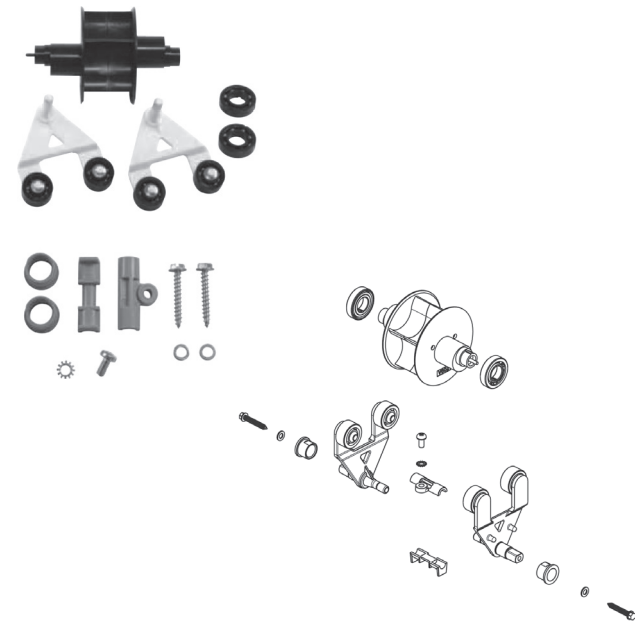

Pod Kit
HWN116

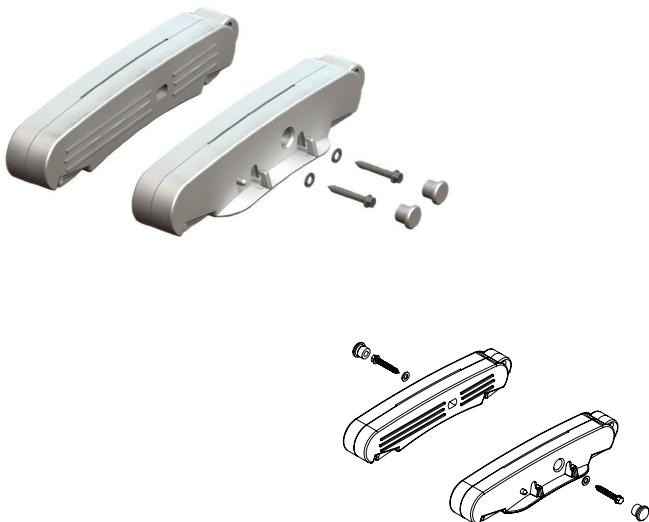

Turbine Bearings (2 Pack)
HWN112

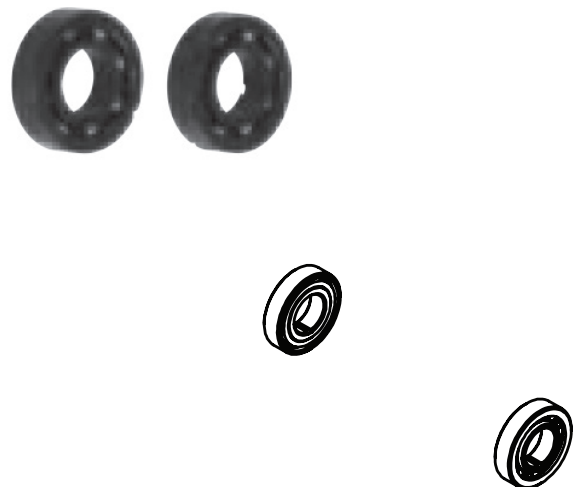



WARRANTY REGISTRATION CARD



Include a copy of your receipt and return this form within 15 days of purchase. The additional information requested is to help us understand our customers. The information is NOT sold or shared with any other party. Thank you for your purchase.

FIRST NAME

LAST NAME

COMPANY NAME (IF POOL SERVICE OR BUILDER)

ADDRESS

CITY

STATE

ZIP CODE

PHONE

FAX

EMAIL

COMMENTS

1. Serial number (found on bottom of cleaner)

5. Name of dealer/builder/service professional where purchased: _____

2. Type of pool:

- Vinyl
- Fiberglass
- Gunitite
- Other

6. Pool is _____ years old.

7. What cleaner is this replacing?

3. Cleaner model:

- Concrete
- Vinyl/fiberglass

8. Are you a:

- Consumer
- Pool Service Technician
- Pool Builder
- Other

4. Date of purchase: _____

Please complete and mail with receipt to:
AquaStar Pool Products, Inc.
Warranty Registration Dept. 104
2340 Palma Drive
Ventura, CA 93003

Or fax to:
877.276.POOL (7665)
Outside the U.S.: +1.949.336.1940



AUTOMATIC SUCTION POOL CLEANER

Please fill out warranty information on reverse side and mail to:

AquaStar Pool Products, inc.
Warranty Registration Dept. 104
2340 Palma Drive
Ventura, CA 93003

Don't forget to include a copy of your receipt
as proof of purchase

Rev 042021
P/N 02020708