

20" PERFECT CIRCLE™ SUCTION OUTLET COVER AND FOUR-PORT MANUFACTURED SUMP



VGBA CERTIFIED SPECIFICATIONS

Open Area
51.24 in²

For SOFA Specific Flow Ratings and specifications please scan QR code or visit www.aquastarpoolproducts.com/flowcode



FEATURES

For concrete pools and spas

Four threaded ports:

Bottom 2 1/2" Spigot x 2" Socket x 2" NPT

Certified, Listed, and Labeled in conformance with APSP/ANSI/ICC-16 2017 and NSF/ANSI/CAN 50 standards

Disposable plaster shield prevents debris from entering sump and retains shape during pool finish

Water stop around edges prevents water leaks

Unique circle design is filled with plaster/pebble to blend into pool finish

Manufactured superior UV-resistant PVC sump

#316 stainless steel screws

Replace the 20" Round Suction Outlet Cover, Baffles, and Screws every five years.

NOTICE: White assemblies will come with white PVC sump, all other colors are shipped with medium Gray.

1 per case

U.S. Patents www.aquastarpoolproducts.com/patents

Unblockable!

NEW No second drain or SVRS required



NEW

Optional 2" hydrostatic relief valve available
p/n HVK101
See page 35

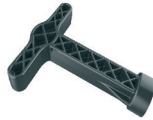

Optional T-Wrench
p/n FC16102

Part # PCxxx

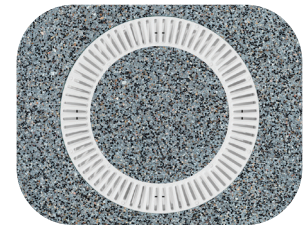

Top view of completed Perfect Circle™ drain

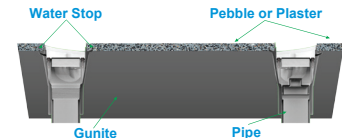

Unique water stop protects against leaks

STANDARD COLORS

- PC101 – White
- PC102 – Black
- PC103 – Light Gray
- PC105 – Dark Gray

Perfect Circle Drain Cover, Baffles, and Screws, p/n PC20xxx
1 per case

VGBA 2017 Compliant

